

Instruction 106-5033
4-2-09

Copyright © 2009
by S&S® Cycle, Inc.

All rights reserved.
Printed in the U.S.A.

S&S® Cycle, Inc.

14025 Cty Hwy G
Viola, Wisconsin 54664
Phone: 608-627-1497 • Fax: 608-627-1488
Technical Service Phone: 608-627-TECH (8324)
Technical Service Email: sstech@sscycle.com
Website: www.sscycle.com • www.ss-offroad.com



Installation Instructions: S&S® Exhaust System, PN106-5013 For 2008 – Up Polaris® Ranger RZR® and RZR®

DISCLAIMER:

S&S parts are designed for high performance, closed course, racing applications and are intended for the very experienced rider only. The installation of S&S parts may void or adversely affect your factory warranty. In addition such installation and use may violate certain federal, state, and local laws, rules and ordinances as well as other laws when used on motor vehicles used on public highways, especially in states where pollution laws may apply. Always check federal, state, and local laws before modifying your vehicle. It is the sole and exclusive responsibility of the user to determine the suitability of the product for his or her use, and the user shall assume all legal, personal injury risk and liability and all other obligations, duties, and risks associated therewith.

The words Polaris®, Polaris RZR® and all Polaris part numbers and model designations are used in reference only.

SAFE INSTALLATION AND OPERATION RULES:

Before installing your new S&S part it is your responsibility to read and follow the installation and maintenance procedures in these instructions and follow the basic rules below for your personal safety.

- Gasoline is extremely flammable and explosive under certain conditions and toxic when breathed. Do not smoke. Perform installation in a well ventilated area away from open flames or sparks.
- If vehicle has been running, wait until engine and exhaust pipes have cooled down to avoid getting burned before performing any installation steps.
- Before performing any installation steps disconnect battery to eliminate potential sparks and inadvertent engagement of starter while working on electrical components.
- Read instructions thoroughly and carefully so all procedures are completely understood before performing any installation steps. Contact S&S with any questions you may have if any steps are unclear or any abnormalities occur during installation or operation of vehicle with a S&S part on it.
- Consult an appropriate service manual for your vehicle for correct disassembly and reassembly procedures for any parts that need to be removed to facilitate installation.
- Use good judgment when performing installation and operating vehicle. Good judgment begins with a clear head. Don't let alcohol, drugs or fatigue impair your judgment. Start installation when you are fresh.
- Be sure all federal, state and local laws are obeyed with the installation.
- For optimum performance and safety and to minimize potential damage to vehicle or other components, use all mounting hardware that is provided and follow all installation instructions.
- Engine exhaust fumes are toxic and poisonous and must not be breathed. Run vehicle in a well ventilated area where fumes can dissipate.

IMPORTANT NOTICE:

Statements in this instruction sheet preceded by the following words are of special significance.

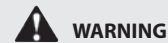

WARNING

Means there is the possibility of injury to yourself or others.



CAUTION

Means there is the possibility of damage to the part or vehicle.

NOTE

Other information of particular importance has been placed in italic type.

S&S recommends you take special notice of these items.

WARRANTY:

All S&S parts are guaranteed to the original purchaser to be free of manufacturing defects in materials and workmanship for a period of six (6) months from the date of purchase. Merchandise that fails to conform to these conditions will be repaired or replaced at S&S's option if the parts are returned to us by the purchaser within the six month warranty period or within 10 days thereafter.

In the event warranty service is required, the original purchaser must call or write S&S immediately with the problem. Some problems can be rectified by a telephone call and need no further course of action.

A part that is suspect of being defective must not be replaced by a Dealer without prior authorization from S&S. If it is deemed necessary for S&S to make an evaluation to determine whether the part was defective, a return authorization number must be obtained from S&S. The parts must be packaged properly so as to not cause further damage and be returned prepaid to S&S with a copy of the original invoice of purchase and a detailed letter outlining the nature of the problem, how the part was used and the circumstances at the time of failure. If after an evaluation has been made by S&S and the part was found to be defective, repair, replacement or refund will be granted.

ADDITIONAL WARRANTY PROVISIONS:

- (1) S&S shall have no obligation in the event an S&S part is modified by any other person or organization.
- (2) S&S shall have no obligation if an S&S part becomes defective in whole or in part as a result of improper installation, improper maintenance, improper use, abnormal operation, or any other misuse or mistreatment of the S&S part.
- (3) S&S shall not be liable for any consequential or incidental damages resulting from the failure of an S&S part, the breach of any warranties, the failure to deliver, delay in delivery, delivery in non-conforming condition, or for any other breach of contract or duty between S&S and a customer.
- (4) S&S parts are designed exclusively for use in Polaris® RZR®. S&S shall have no warranty or liability obligation if an S&S part is used in any other application.

TOOL REQUIREMENTS:

- 1/2" wrenches
- 13mm wrenches
- 6mm hex key socket
- 5/32" hex key wrench
- Exhaust spring puller
- Torque wrenches ft-lb. and in-lb.

WARNING

- **The safety of vehicle occupants is dependent on proper installation of this product. If you are not certain of your capabilities or do not have the correct tools for this installation, please consult a dealer to have it done. Improper installation of this product could result in injury or death to the rider.**
- **Be sure to disconnect the battery of your vehicle before starting on this procedure. Accidental starting of the vehicle could cause injury to you or others around you during the installation.**

NOTE: It is not necessary to remove bed from vehicle for this installation.

STOCK EXHAUST REMOVAL STANDARD RZR (If you have a RZR go to next section)

- 1- With spring puller remove the two springs that hold the intermediate pipe to the primary pipe.

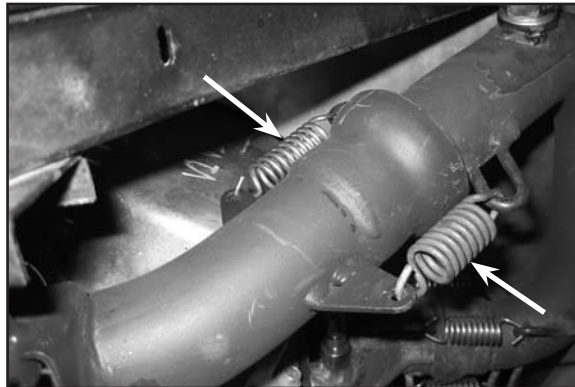

Picture 1

- 2- Loosen muffler band clamp.
- 3- Remove two springs that hold primary pipe to the frame. Slide out primary pipe.
- 4- Remove muffler from vehicle.
- 5- Remove four screws that hold exhaust manifold to engine. Remove manifold.
- 6- Inspect rubber grommets that hold muffler for excessive wear, replace if necessary.

STOCK EXHAUST REMOVAL RZRS

- 1- With spring puller, remove the two springs that hold the intermediate pipe to the primary pipe.



Picture 2

- 2- Loosen muffler band clamp.
- 3- Remove spring that hold primary pipe to frame. Slide out primary pipe.
- 4- Remove muffler from vehicle.
- 5- Remove two bolts (13mm hex) that hold header bracket to head. Note it may be necessary to remove sway bar clamps (1/2" hex) and lower sway bar to get at the lower bolt.



Picture 3



Picture 4

- 6- Remove four screws (6mm hex key) that hold exhaust header to engine. Remove header.
- 7- Inspect rubber grommets that hold muffler for excessive wear, replace if necessary.

S&S EXHAUST INSTALLATION: RZR AND RZRS

- 1- Assemble header to mid pipe with springs supplied.

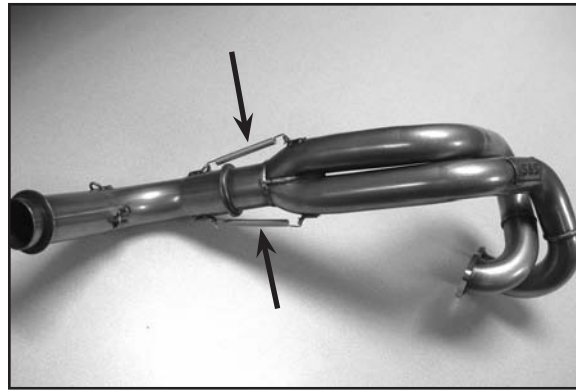

Picture 5

- 2- Install new header using the supplied header gasket, 8mm screws, lock washers and red Loctite®.
- 3- Torque header screws to 18-20 ft-lbs.
- 4- Using the supplied 10-24 x 5/8" socket head cap screws and lock washers. Install spark arrestor and muffler end cap. Use the supplied red Loctite on threads and torque to 50 in-lbs.



Picture 6



Picture 7

5- Install supplied exhaust donut gasket on end of mid pipe. **See Picture 8.** Slide muffler mounting arms into grommets making sure donut gasket aligns with muffler and install the remaining three springs connecting the mid pipe to the muffler. **See Picture 9.**

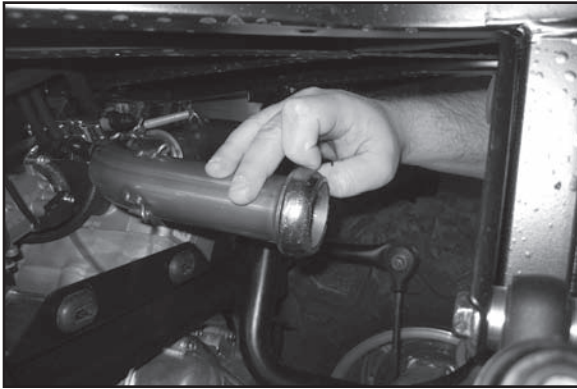

Picture 8

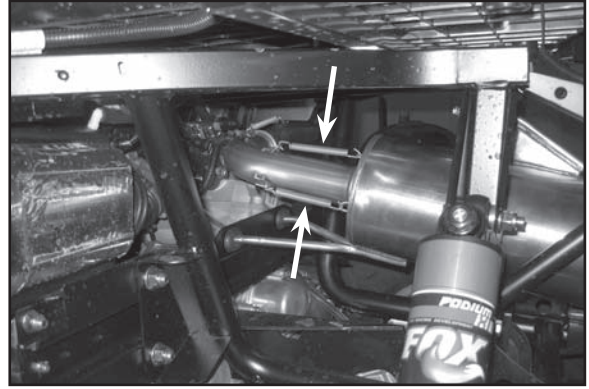

Picture 9

6- Install the bow tie safety clip in the muffler top mount. This clip will keep the muffler from falling in the event all three muffler springs were to fail. **See Picture 10.**

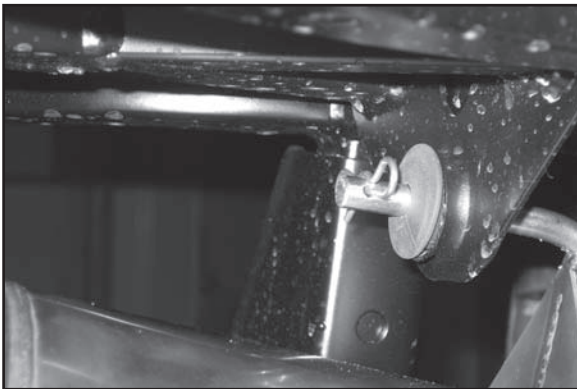

Picture 10



Picture 11 - Installed Exhaust

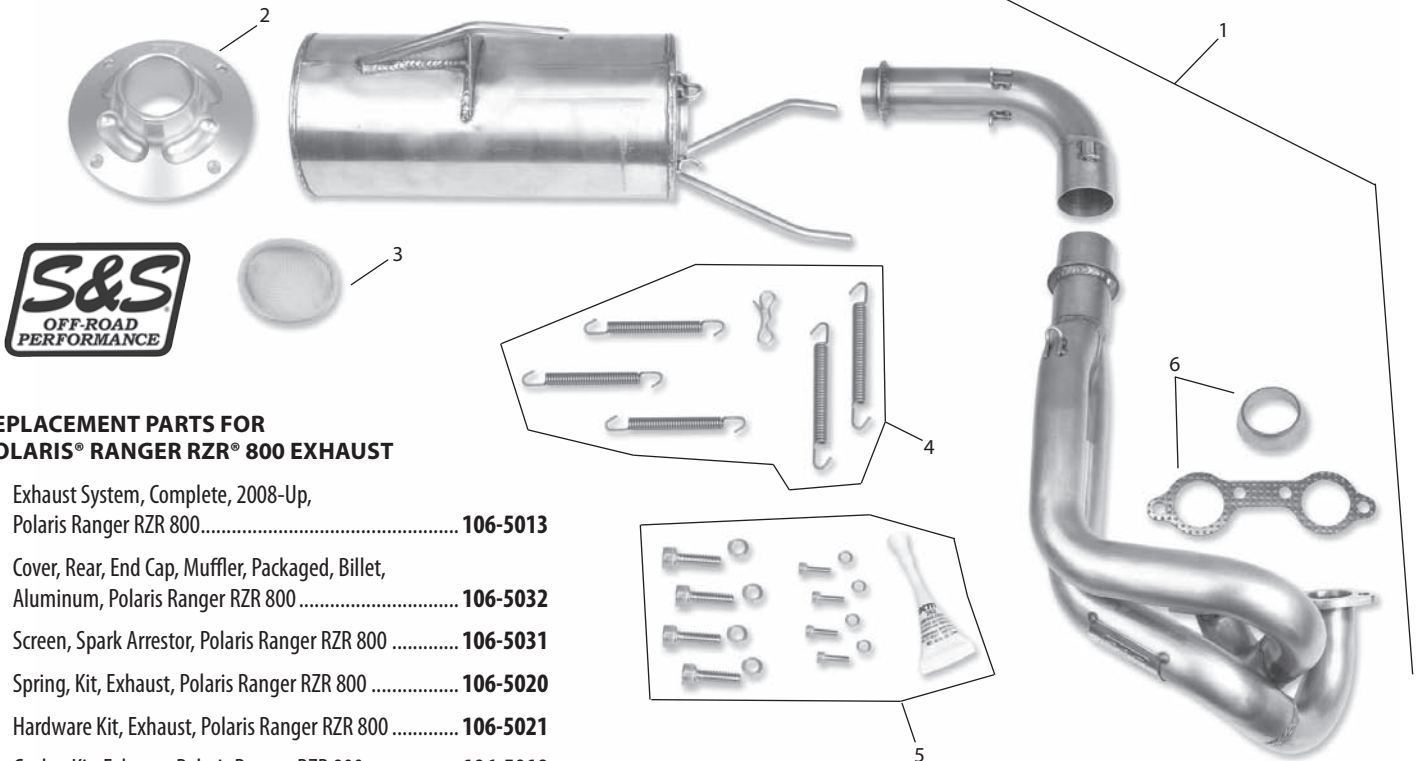

**REPLACEMENT PARTS FOR
POLARIS® RANGER RZR® 800 EXHAUST**

- 1- Exhaust System, Complete, 2008-Up, Polaris Ranger RZR 800..... **106-5013**
- 2- Cover, Rear, End Cap, Muffler, Packaged, Billet, Aluminum, Polaris Ranger RZR 800..... **106-5032**
- 3- Screen, Spark Arrestor, Polaris Ranger RZR 800 **106-5031**
- 4- Spring, Kit, Exhaust, Polaris Ranger RZR 800 **106-5020**
- 5- Hardware Kit, Exhaust, Polaris Ranger RZR 800 **106-5021**
- 6- Gasket Kit, Exhaust, Polaris Ranger RZR 800..... **106-5019**